

ADDITIONAL INSPECTION & MAINTENANCE

Ref No CAWBIM.

SCHEDULE

Iss No 01.

for

Anti Wrap Swing Bearings

This Equipment should be maintained in accordance with the requirements in the Playdale inspection and maintenance schedule for Junior Swings / Cradle Swings / 2 Bay Junior Swing / 2 Bay Cradle Swing.

Anti Wrap Bearing wear check

Lift chain bearing strap assembly at each bearing point.
Check movement between bearing strap (JS005D)
and bush (JS005C),
if the movement exceeds 8mm, replace worn parts.

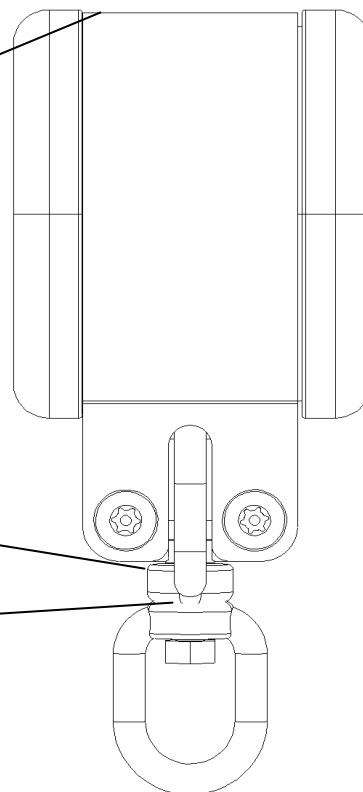

If gap between shoulder of swivel and end face of block
exceeds 5mm the unit should be disassembled and
worn parts need to be replaced.

Check gap in between shoulders of swivel,
if this exceeds 5mm, replace chain assembly

Anti wrap bearing assembly: To fit and remove seat &
chain assembly, loosen security bolts F430, remove just
one bolt, prize off JS005E, fit or remove swivel on
seat & chain assembly CH42, CH43
reassemble and fully tightening
both security bolts F430.

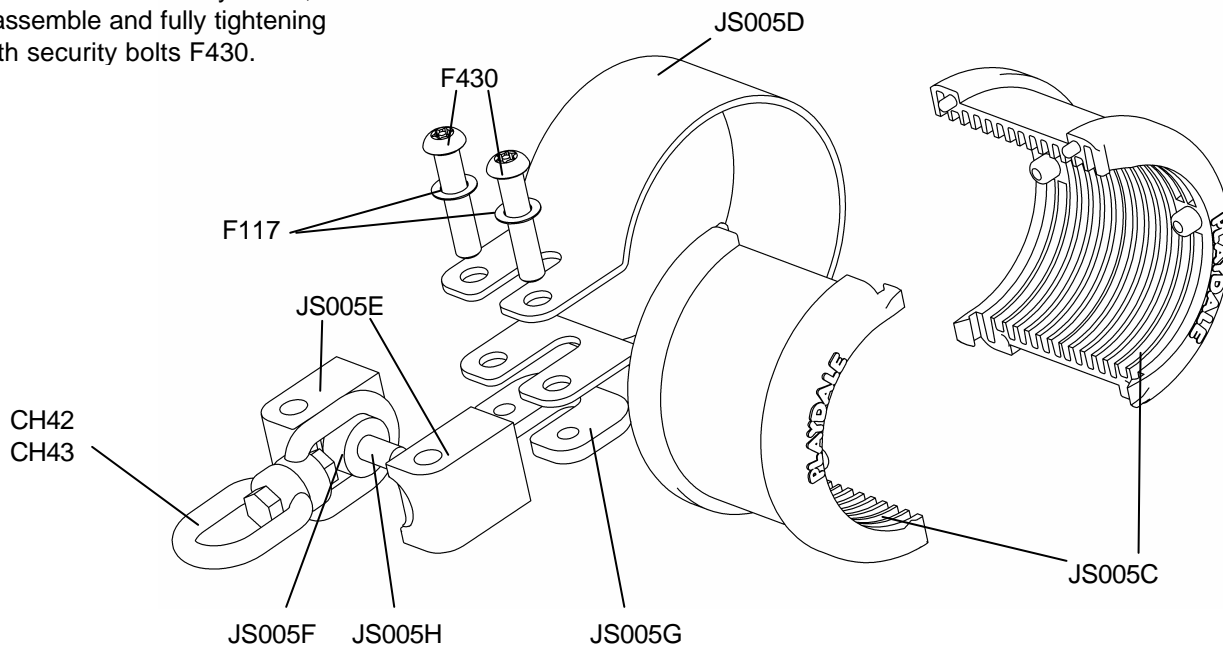

Maintenance

Any worn or damaged parts should be replaced with PLAYDALE authorised components. We DO NOT recommend the use of homemade parts.

All replacement components should be fitted as shown in exploded drawing above.